

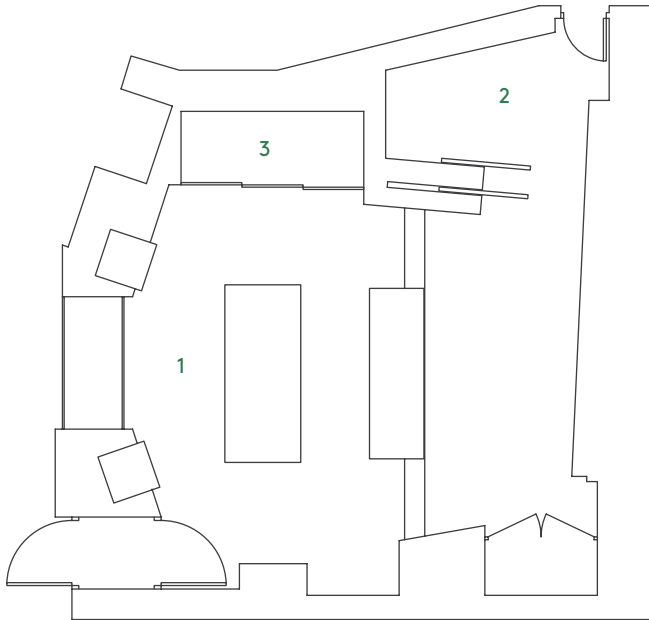

Studio C



- 1. Control Room 19m²
- 2. Overdub Booth 9m²
- 3. Machine Bay 3m²

Equipment

- Neve VR 72 Channel Console with Flying Faders v3.1 Automation
- Pro Tools 12 HDX
- Logic X
- Prism ADA-8/ADA-8x Convertors (24 inputs and 56 outputs)
- PMC BB5/XBD Active Main Monitoring System
- Yamaha NS10
- Nearfield monitors (subject to availability); , Unity Audio Rock, Focal Twin 6 BE, Genelec 8351a, Adams S3X-H, ProAc Studio 100, Acoustic Energy AE22, Genelec 1031a, Auratone 5c
- Bryston and Quad Amplifiers
- Emagic Initor 8 MIDI interface
- Overdub Booth
- Neve 33609
- Prism Maselec MLA-2
- Tube Tech CL-1A
- Urei 1176 Silver Face (x3)
- GML 8200
- Prism Maselec MEA-2
- Pultec EQH 2 (x2)
- Pultec MEQ 5 (x2)
- Summit EQ-F100
- AMS RMX-16
- AMS DMX
- Bel Flanger
- Bricasti M7
- EMT 244 Reverb
- Eventide H3000 D/SE
- Lexicon 480L
- Lexicon 224X
- Lexicon PCM 70
- Plate Reverbs (available on request)
- Roland DimD
- Roland SDE-3000
- T.C. Electronics 2290 Digital Delay
- T.C. Electronics M5000
- Yamaha REV 5
- Yamaha SPX 900 Multi FX
- AI Smart C1 Stereo Compressor
- DBX 160 Compressor (x2)
- Drawmer DS-201 Gates
- Empirical Labs Distressors EL8-X (with British Mode) (x2)
- Manley Stereo "Vari-MU" Limiter Compressor

Outboard Including